



INDIA TRADE PROMOTION ORGANISATION



INTERNATIONAL
EXHIBITION
cum
CONVENTION
CENTRE (IECC)

Pragati Maidan, New Delhi

A Unique Symbol
of

*New
India*



INDIA TRADE PROMOTION ORGANISATION



INTERNATIONAL EXHIBITION cum CONVENTION CENTRE (IECC)

ITPO is now implementing its ambitious plan of re-development of its landmark fairground Pragati Maidan, involving a modern state-of-the-art International Exhibition-cum-Convention Centre (IECC) in two phases, bringing it at par with the best Exhibition and Convention Centres across the world.



To experience a virtual walkthrough of IECC please scan the QR code with your mobile device.

INTERNATIONAL EXHIBITION cum CONVENTION CENTRE (IECC)

AREA STATEMENT - CONVENTION CENTRE

CONVENTION CENTER- LEVEL- 1					
Floor to Floor Height: 5.4 mtrs					
S. No.	DESCRIPTION	FLOOR AREA		DIMENSIONS (IN M)	
		(IN SQ.M)	(IN SQ.FT)	L	B
PREMIUM COMPLEX					
1	PREMIUM METTING ROOM (100 PAX)	196.91	2119.54	9.70	20.25
2	PREMIUM METTING ROOM (50 PAX)	119.93	1290.93	12.58	9.50
3	BREAK OUT ROOM	27.58	296.87	3.90	7.15
4	PREMIUM PRE- FUNCTION AREA	138.89	1495.01	10.50	13.25
5	PREMIUM WAITING LOUNGE	38.42	413.55	6.43	6.00
6	PREMIUM DINNING ROOM	73.03	786.09	10.50	6.98
A	SUB-TOTAL	594.76	6402.00		
MEETING COMPLEX					
1	MEETING ROOM (200 PAX) - 1	272.00	2927.81	21.30	13.00
2	MEETING ROOM (200 PAX) - 2	269.00	2895.52	21.20	13.00
3	MEETING ROOM (200 PAX) - 3	272.00	2927.81	21.03	13.00
4	MEETING ROOM (200 PAX) - 4	269.00	2895.52	21.03	13.00
5	MEETING ROOM (100 PAX) - 1	127.11	1368.21	10.25	12.70
6	MEETING ROOM (100 PAX) - 2	121.05	1368.34	10.25	12.70
7	MEETING ROOM (100 PAX) - 3	127.11	1368.34	10.25	12.70
8	MEETING ROOM (100 PAX) - 4	121.05	1303.10	10.25	12.70
9	MEETING ROOM (100 PAX) - 5	135.66	1460.38	10.38	12.70
10	MEETING ROOM (100 PAX) - 6	135.66	1460.38	10.38	12.70
11	MEETING ROOM (50 PAX) - 1	63.50	683.51	10.13	6.25
12	MEETING ROOM (50 PAX) - 2	63.50	683.51	10.13	6.25
13	MEETING ROOM (50 PAX) - 3	63.50	683.51	10.13	6.25
14	MEETING ROOM (50 PAX) - 4	63.50	683.51	10.13	6.25
15	MEETING ROOM (50 PAX) - 5	70.53	759.13	10.75	7.03
16	MEETING ROOM (50 PAX) - 6	70.53	759.13	10.75	7.03
17	MEETING ROOM (50 PAX) - Fixed - 1	61.16	658.33	9.68	6.33
18	MEETING ROOM (50 PAX) - Fixed - 2	60.92	655.74	9.68	6.33
19	MEETING ROOM (50 PAX) - Fixed - 3	61.16	658.33	9.68	6.33
20	MEETING ROOM (50 PAX) - Fixed - 4	60.92	655.74	9.68	6.30
B	SUB-TOTAL	2488.85	26789.98		
SUPPORT FACILITIES					
1	PRE - FUNCTION AREA	2229.10	23994.03	-	-
2	VIP RECEPTION	381.31	4104.42	-	-
3	GENERAL RECEPTION + FOYER	481.82	5186.31	-	-
C	SUB-TOTAL	3092.23	33284.76		
D	GRAND TOTAL LEVEL- 1 (A+B+C)	6175.84	66476.74		

CONVENTION CENTER- LEVEL- 2					
Floor to Floor Height: 9.0 mtrs					
S. No.	DESCRIPTION	FLOOR AREA		DIMENSIONS (IN M)	
		(IN SQ.M)	(IN SQ.FT)	L	B
G-20 SUMMIT MEETING ROOM					
1	G-20 METTING ROOM (157 Fixed + 72 Floating PAX)	654.81	7048.37	26.05	26.05
2	BREAK OUT ROOM - 1	26.65	286.86	7.25	3.83
A	SUB-TOTAL	681.46	7335.23		
MEETING COMPLEX					
1	MEETING ROOM (500 PAX) - 1 LEADERS' LOUNGE	581.00	6253.88	19.38	30.38
2	MEETING ROOM (500 PAX) - 2 LEADERS' DINING	581.00	6253.88	19.38	30.38
3	COMBINED MEETING ROOM (1000 PAX)	1162.00	12507.77	36.75	30.38
4	AUDITORIUM (900 PAX) - 1	931.90	10030.90	-	-
5	AUDITORIUM (600 PAX) - 2	703.81	7575.81	-	-
B	SUB-TOTAL	2797.71	30114.55		
SUPPORT FACILITIES					
1	VIP LOUNGE	182.22	1961.42	-	-
2	CAFE	183.63	1976.59	-	-
3	TEA HOUSE - 1 (ART GALLERY)	373.00	4014.97	-	-
4	TEA HOUSE - 2	386.58	4161.15	-	-
5	AMPITHEATRE	2078.50	22372.97	-	-
6	PRESIDENTIAL LOBBY	100.50	1081.78	-	-
7	PRE - FUNCTION AREA	-	-	-	-
8	RECEPTION	-	-	-	-
C	SUB-TOTAL	3304.43	35568.88		
D	GRAND TOTAL LEVEL- 2 (A+B+C)	6783.60	73018.67		
CONVENTION CENTER- LEVEL- 3					
Floor to Floor Height varies					
MULTIFUNCTION AND PLENARY HALL					
1	MULTI - FUNCTION HALL 1 (false ceiling height 11 to 12.2 m) (1070 PAX)	969.45	10435.16	32.15	30.67
2	MULTI - FUNCTION HALL 2 (false ceiling height 11 to 12.2 m) (1070 PAX)	969.45	10435.16	32.15	30.67
3	MULTI - FUNCTION HALL 3 (false ceiling height 11 to 12.2 m) (840 PAX)	1242.70	13376.42	41.90	31.28
4	MULTI - FUNCTION HALL 4 (false ceiling height 11 to 12.2 m) (840 PAX)	1242.70	13376.42	41.90	31.28
5	MULTI - FUNCTION HALL 1 AND 3 COMBINED (2100 PAX)	2077.98	22367.38	32.15	66.85
6	MULTI - FUNCTION HALL 2 AND 4 COMBINED (2100 PAX)	2656.00	28589.18	41.90	66.85
7	MULTI - FUNCTION HALL - ALL COMBINED (4240 PAX)	5131.90	55239.77	83.57	66.85
8	PLENARY HALL (false ceiling height 9.5 to 14 m) (3000 PAX)	3107.58	33449.99	-	-
9	MULTI FUNCTIONAL AND PLENARY HALL COMBINED (7720 PAX)	8239.48	88689.76	-	-
A	SUB-TOTAL	8239.48	88689.76		
SUPPORT FACILITIES					
1	PRE - FUNCTION (height varies from 5.8 to 12.5m)	2720.00	29278.08	-	-
2	SPECIAL LOUNGE (floor to floor height-6.9m)	103.88	1118.16	-	-
3	SPECIAL LOBBY (floor to floor height-6.9m)	67.40	725.49	-	-
B	SUB-TOTAL	2891.28	31121.74		
C	GRAND TOTAL LEVEL- 3 (A+B)	11130.76	119811.50		

CONVENTION CENTER- LEVEL- 4					
False Ceiling Height: 6.5 - 8 mtrs					
S. No.	DESCRIPTION	FLOOR AREA		DIMENSIONS (IN M)	
		(IN SQ.M)	(IN SQ.FT)	L	B
SUPPORT FACILITIES					
1	PRE - FUNCTION EXCLUDING PLENARY AND MULTI FUNCTION HALL	1890.80	20352.57	-	-
A	SUB-TOTAL	1890.80	20352.57		
B	GRAND TOTAL LEVEL- 4 (A)	1890.80	20352.57		

AMPHITHEATRES		
1	AMPHITHEATRE NEAR CONVENTION CENTRE (BELOW PLENARY)	3000 pax
2	AMPHITHEATRE NEAR HALL-A1	900 pax
3	AMPHITHEATRE NEAR HALL-A3	900 pax
4	AMPHITHEATRE NEAR HALL-A5	900 pax
5	AMPHITHEATRE NEAR LAKE	450 pax

CONVENTION CENTER- LEVEL- 5					
Floor to Bottom of Truss Height: 2.7 mtrs					
SUPPORT FACILITIES					
1	AV LOUNGE	40.30	433.79	-	-
2	PRESS LOUNGES L5-PR-L0-L1	36.21	389.76	-	-
3	PRESS LOUNGES L5-PR-L0-L2	36.21	389.76	-	-
4	INTERPRETER ROOMS L5 - INTP - 01	59.30	638.31	-	-
5	INTERPRETER ROOMS L5 - INTP - 02	38.97	419.47	-	-
6	INTERPRETER ROOM L5 - INTP - 03	47.46	510.86	-	-
7	INTERPRETER ROOMS L5 - INTP - 04	47.46	510.86	-	-
8	INTERPRETER ROOMS L5 - INTP - 05	38.97	419.47	-	-
9	INTERPRETER ROOMS L5 - INTP - 06	59.30	638.31	-	-
	INTERPRETER ROOMS SUB-TOTAL	291.46	3137.28	-	-
A	SUB-TOTAL	404.18	4350.59		
B	GRAND TOTAL LEVEL- 5 (A)	404.18	4350.59		

Summary		
Level	Area(in sq.m)	Area(in sq.ft)
Level-01	6175.84	66476.74
Level-02	6783.60	73018.67
Level-03	11130.76	119811.50
Level-04	1890.80	20352.57
Level-05	404.18	4350.59
Total	26385.18	284010.07

In Convention Centre, live-load bearing capacity of all floors is 5 KN/cu.m. and roof is 2 KN/cu.m.

INTERNATIONAL EXHIBITION cum CONVENTION CENTRE (IECC)

AREA STATEMENT - EXHIBITION HALLS A1 to A6

EXHIBITION HALL		HALL A1/A2						HALL A3						HALL A4a						Summary		
LEVEL	DESCRIPTION	L	B	AREA (in sq.m)	AREA (in sq.ft)	FLOOR TO FLOOR HEIGHT (in m)	CLEAR HEIGHT BELOW TRUSS (in m)	L	B	AREA (in sq.m)	AREA (in sq.ft)	FLOOR TO FLOOR HEIGHT (in m)	CLEAR HEIGHT BELOW TRUSS (in m)	L	B	AREA (in sq.m)	AREA (in sq.ft)	FLOOR TO FLOOR HEIGHT (in m)	CLEAR HEIGHT BELOW TRUSS (in m)	Exhibition hall	Area(in sq.m)	Area(in sq.ft)
GROUND FLOOR	Circulation area(non A.C.)	16.00 x 36.60 (avg.)		503.81	5423.01	7	5	18.26 x 15.50 (avg.)		258.46	2782.06	7	5	66.75 x 10.2 (avg.)		566.59	6098.77	7	5	A1	21807.00	234730.55
	Pre-function(A.C.)	14.85 x 50.00 (avg.)		740.97	7975.80	7	5	34.00 x 20.15 (avg.)		635.94	6845.26	7	5	32.50 x 20.10 (avg.)		603.63	6497.47	7	5	A2	21807.00	234730.55
	Exhibition space	93.00 x 79.00 (avg.)		6947.56	74783.54	14	10	70.83 x 72.50 (avg.)		5099.87	54895.00	14	10	66.75 x 75.5		4834.36	52037.05	14	10	A3	14719.21	158437.58
	Other support facilities	-	-	1223.00	13164.37			-	-	775.00	8342.10			-	-	588.52	6334.83			A4a	14819.95	159521.94
	Meeting rooms	3.5	4.4	92.40	994.59	7	5				0.00					0.00				A4b	14839.07	159727.75
	Sub-total (A)			9507.74	102341.31				6769.27	72864.42					6593.10	70968.13			A5	28310.26	304731.64	
MEZZANINE LEVEL	Circulation Area	16.00 x 36.00 (avg.)		498.00	5360.47	7	5	18.26 x 15.50 (avg.)		255.62	2751.49	7	5	66.75 x 10.2 (avg.)		613.50	6603.71	7	5	A6	30592.99	329302.94
	Meeting rooms				0.00					0.00				-	-	540.00	5812.56	7	5	Total	146895.48	1581182.95
	Kitchen + Counter Area			178.00	1915.99			27.91	5.7	159.08	1712.34	7	5				0.00					
	Food court area	12.00 x 57.50 (avg.)		680.05	7320.06	7	5			415.00	4467.06	7	5				0.00					
	Other support facilities	-	-	1140.00	12270.96			-	-	415.00	4467.06			-	-	412.17						
	Sub-total (B)			2496.05	26867.48				1244.70	13397.95					1565.67	16852.87						
LEVEL-01	Circulation area	16.00 x 36.60 (avg.)		503.81	5423.01	14	10	18.26 x 15.50 (avg.)		255.62	2751.49	7	5	66.75 x 10.2 (avg.)		613.50	6603.71	7	5			
	Pre-function	14.85 x 50.00 (avg.)		778.00	8374.39	14	10	34.00 x 20.15 (avg.)		666.46	7173.78	7	5	40.90 x 20.10 (avg.)		615.50	6625.24	7	5			
	Exhibition space	93.00 x 79.00 (avg.)		6911.00	74390.00	14	10	70.83 x 72.50 (avg.)		5019.16	54026.24	14	10	66.75 x 75.5		4865.62	52373.53	14	10			
	Other support facilities	-	-	1518.00	16339.75			-	-	764.00	8223.70			-	-	566.56	6098.45					
	Meeting rooms	3.5	4.4	92.40	994.59	14	10				0.00					0.00						
	Sub-total (C)			9803.21	105521.75				6705.24	72175.20					6661.18	71700.94						
	Grand Total (A+B+C)			21807.00	234730.55				14719.21	158437.58					14819.95	159521.94						
EXHIBITION HALL		HALL A4b						HALL A5						HALL A6								
LEVEL	DESCRIPTION	L	B	AREA (in sq.m)	AREA (in sq.ft)	FLOOR TO FLOOR HEIGHT (in m)	CLEAR HEIGHT BELOW TRUSS (in m)	L	B	AREA (in sq.m)	AREA (in sq.ft)	FLOOR TO FLOOR HEIGHT (in m)	CLEAR HEIGHT BELOW TRUSS (in m)	L	B	AREA (in sq.m)	AREA (in sq.ft)	FLOOR TO FLOOR HEIGHT (in m)	CLEAR HEIGHT BELOW TRUSS (in m)			
GROUND FLOOR	Circulation area(non A.C.)	66.75 x 10.2 (avg.)		547.11	5889.09	7	5	19.25 x 15.50 (avg.)		258.65	2784.11	7	5	66.65 x 36.13 (avg.)		802.00	8632.73	7.5	5.75			
	Pre-function(A.C.)	32.50 x 20.10 (avg.)		603.63	6497.47	7	5	44.41 x 20.15 (avg.)		992.71	10685.53	7	5	55.616 x 20.90 (avg.)		915.19	9851.11	7.5	5.75			
	Exhibition space	66.75 x 75.5		4850.00	52205.40	14	10	88.25 x 128 (avg.)		11020.25	118621.97	14	10	83.0 x 118.90		9477.61	102016.99	22.5	18.50			
	Other support facilities	-	-	568.00	6113.95			-	-	1100.00	11840.40	7	5	-	-	1392.00	14983.49	7.5	5.75			
	Meeting rooms																					
	Sub-total (A)			6568.74	70705.92				13371.61	143932.01					12586.80	135484.32						
MEZZANINE LEVEL	Circulation Area	66.75 x 10.2 (avg.)		624.42	6721.26	7	5	19.25 x 15.50 (avg.)		255.00	2744.82	7	5	66.65 X 37.43 (avg.)		798.00	8589.67	7.5	5.75			
	Meeting rooms																					
	Kitchen + Counter Area	27.91	5.1	159.00	1711.48	7	5	44.41	5.50	252.00	2712.53	7	5	66.65 X 35.93 (avg.)		915.00	9849.06	7.5	5.75			
	Food court area	-	-	387.00	4165.67	7	5	-	-	602.48	6485.09	7	5									
	Other support facilities	-	-	412.66	4441.87			-	-	465.57	5011.40	7	5	-	-	908.00	9773.71	7.5	5.75			
	Sub-total (B)			1583.08	17040.27				1575.05	16953.84					2621.00	28212.44						
MEZZANINE LEVEL-2 ONLY IN A6	Circulation Area																					
	Kitchen																					
	Food Court																					
	Other support facilities																					
		Sub-total (C)														2813.86	30288.39					
LEVEL-01	Circulation area	66.75 x 10.2 (avg.)		624.42	6721.26	7	5	19.25 x 15.50 (avg.)		255.00	2744.82	7	5	66.65 x 36.13 (avg.)		798.00	8589.67	7.5	5.75			
	Pre-function	40.90 x 20.10 (avg.)		622.79	6703.71	7	5	44.41 x 20.15 (avg.)		1012.52	10898.77	7	5	55.616 x 20.90 (avg.)		940.00	10118.16	7.5	5.75			
	Exhibition space	66.75 x 75.5		4860.04	52313.47	14	10	88.25 x 128 (avg.)		10994.08	118340.28	14	10	83.0 x 118.90		9436.33	101572.66	12.1	8.10			
	Other support facilities	-	-	580.00	6243.12			-	-	1102.00	11861.93			-	-	1397.00	15037.31					
	Meeting rooms																					
	Sub-total (D)			6687.25	71981.56				13363.60	143845.79					12571.33	135317.80						
	Grand Total (A+B+C+D)			14839.07	159727.75				28310.26	304731.64					30592.99	329302.94						

- NOTES:**
1. Rentals for Meeting Rooms would be charged extra.
 2. Live-load bearing capacity:
 - a. Pre-function of Halls A1-A6: 5 KN/cu.m.
 - b. Halls A1-A5 (both floors) and Hall A6 (first floor): 10 KN/cu.m.
 - c. Hall A6 (ground floor): 20 KN/cu.m.
 - d. Loading/unloading areas of Hall A1-A6: 10 KN/cu.m.
 - e. Roof of Hall A1-A6: 2 KN/cu.m.
 - f. Common lobby/corridors/stairs/store/communal/ multi-purpose/ service areas: 4 KN/cu.m.
 - g. Hangar/Open Display at Non-Tower area (above basement): 15 KN/cu.m.

Layout Plan of International Exhibition cum Convention Center (IECC) Pragati Maidan, New Delhi

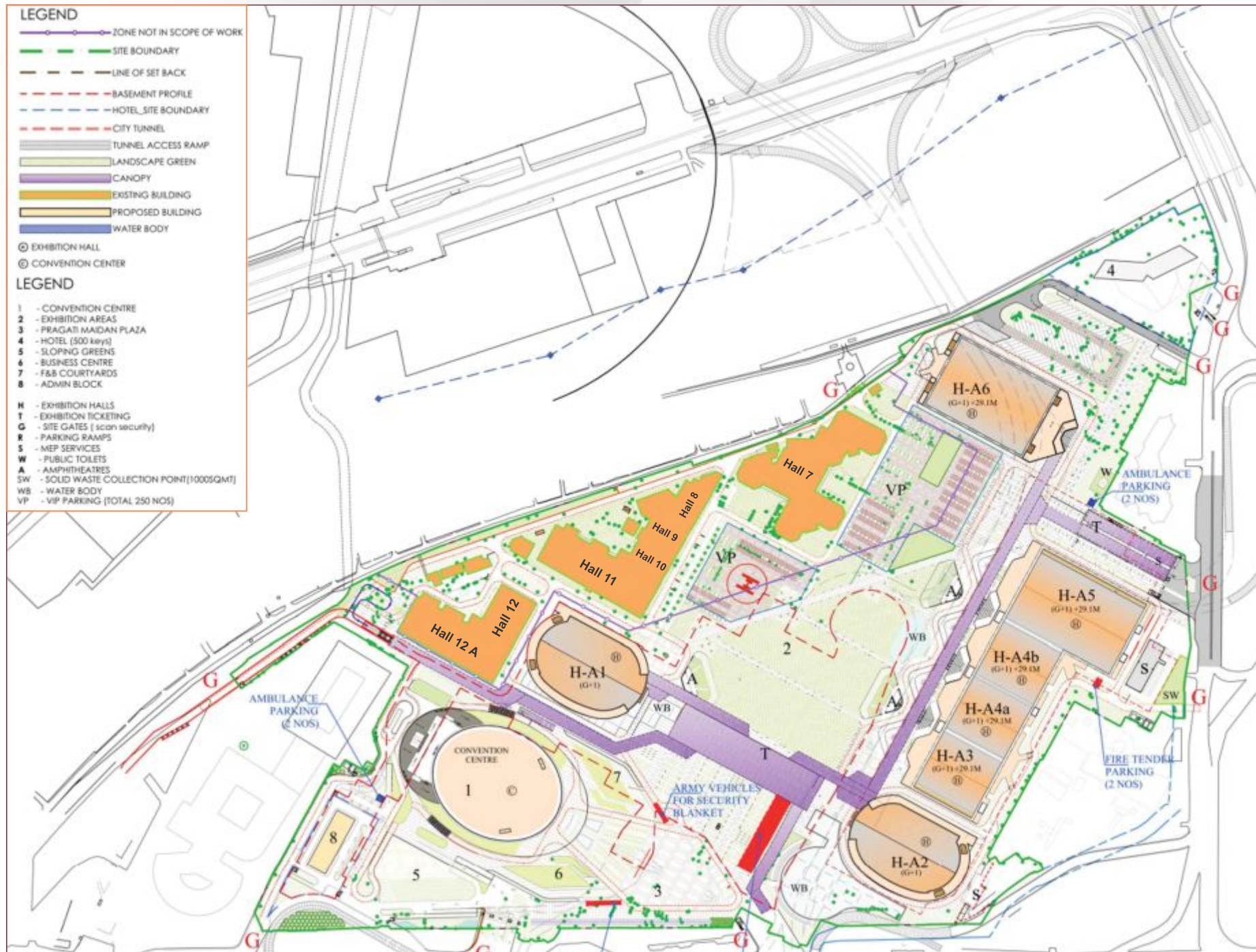



INDIA TRADE PROMOTION ORGANISATION

Promoting 'India' Brand Globally...

India Trade Promotion Organisation (ITPO) as the nodal trade promotion agency of the country, has had a pioneering role in the national trade growth dynamics since its inception. Apart from its role in bringing the Indian business particularly those in the SMEs sector closer to global markets, it pioneered use and popularisation of trade fairs as a tool for trade promotion within the country and abroad. A nonprofit company under Section 25 of Companies Act 1956, it was formed on January 1, 1992 with the merger of the former Trade Development Authority (TDA) with the Trade Fair Authority of India (TFAI). Earlier, the TFAI was formed on April 1, 1977.

Vision

ITPO's vision envisages to be a leader amongst world class trade promotion organisations leveraging India's strengths internationally. It also envisages rapid growth in India's share of global trade and investments quality of our services and customer satisfaction.

Mission

ITPO's mission is to promote, facilitate encourage and coordinate various activities and programmes to enhance India's share of export through trade in goods.

ITPO Organises

- ♦ Dissemination of trade information through meetings, seminars and workshops, online fortnightly 'Indian Export Bulletin' and online trade portal, www.tradeportalofindia.com.
 - ♦ Trade Exhibitions in India and appropriate facilitation
- ♦ India pavilions in product specific fairs and exclusive India Shows overseas
 - ♦ Buyer-Seller Meets (BSMs)
- ♦ Trade related seminars, conferences, workshops and networking events.

HEAD OFFICE

Pragati Bhawan, Pragati Maidan, New Delhi-110001 (India)

Tel: 91-11-23371540 (EPABX), Fax: 91-11-23371492

E.mail: info@itpo.gov.in

Website: www.indiatradefair.com

Trade Portal: www.tradeportalofindia.com

For booking please contact :

Sh. Devender Pal
Dy. General Manager & Single Point Contact
Mobile : +91-9810994832
E-Mail : devenderpal@itpo.gov.in

Sh. Surinder Kumar
Senior Manager
Mobile : +91-9810960930
E-Mail : ksurinder@itpo.gov.in

