

# INDIA INTERNATIONAL IITF 2021 TRADE FAIR

## PRAGATI MAIDAN LAYOUT SERVICES & FACILITIES

### PARKING CAPACITY AT DIFFERENT LOCATIONS:-

LOCATION NO.	TOTAL CAR PARKING	VIP PARKING	EMPLOYEE PARKING
1. Near Gate-1	60	20	40
2. Around Hall-7 & Near Gate-11	0	0	0
3. Near Pragati Bhawan (Triangle)	40	0	40
4. Rear of Hall 8-12 & Periphery Rd	50	0	50
5. Opposite & Behind Hall-5	50	50	0
TOTAL	200	70	130

**PARKING LEGEND:**  
EX- EXHIBITORS' PARKING  
EM- EMPLOYEES' PARKING  
VIP- VVIP/ VIP PARKING

### VENDING POINTS:

W = WATER  
T/C = TEA & COFFEE  
C = COLD DRINK  
M = ICE CREAM  
J = JUICE

GOLF-CART ROUTE & STOPS

PROPOSED LED SCREEN LOCATIONS

PROPOSED ATM LOCATIONS:  
(1 each in foyers of Hall 7, 9-10, 10-11, 12-12A  
5 GF and 5 FF)

### FIRST AID BOOTH:

> Hall 3 Ground Floor foyer  
> Hall 7 foyer (towards Pragati Bhawan)  
> Hall 10-11 foyer

### AMBULANCE LOCATION:

> Opposite Hall-7C (along barricading)  
> Behind Kiosk-6  
> Parking behind Hall 11 (service road)

### WHEELCHAIR BOOTH & ISOLATION ROOM:

> Adjoining Gate-10  
> Adjoining Gate-4

### BRANDING ON WALLS & BARRICADING:

> PROPOSED TOTAL BRANDING ON BARRICADING = 600m LENGTH  
> PROPOSED TOTAL BRANDING ON WALLS = 800m LENGTH  
TOTAL = 1400m LENGTH x 3m HEIGHT  
= 4200 sqm or 45,185 sqft

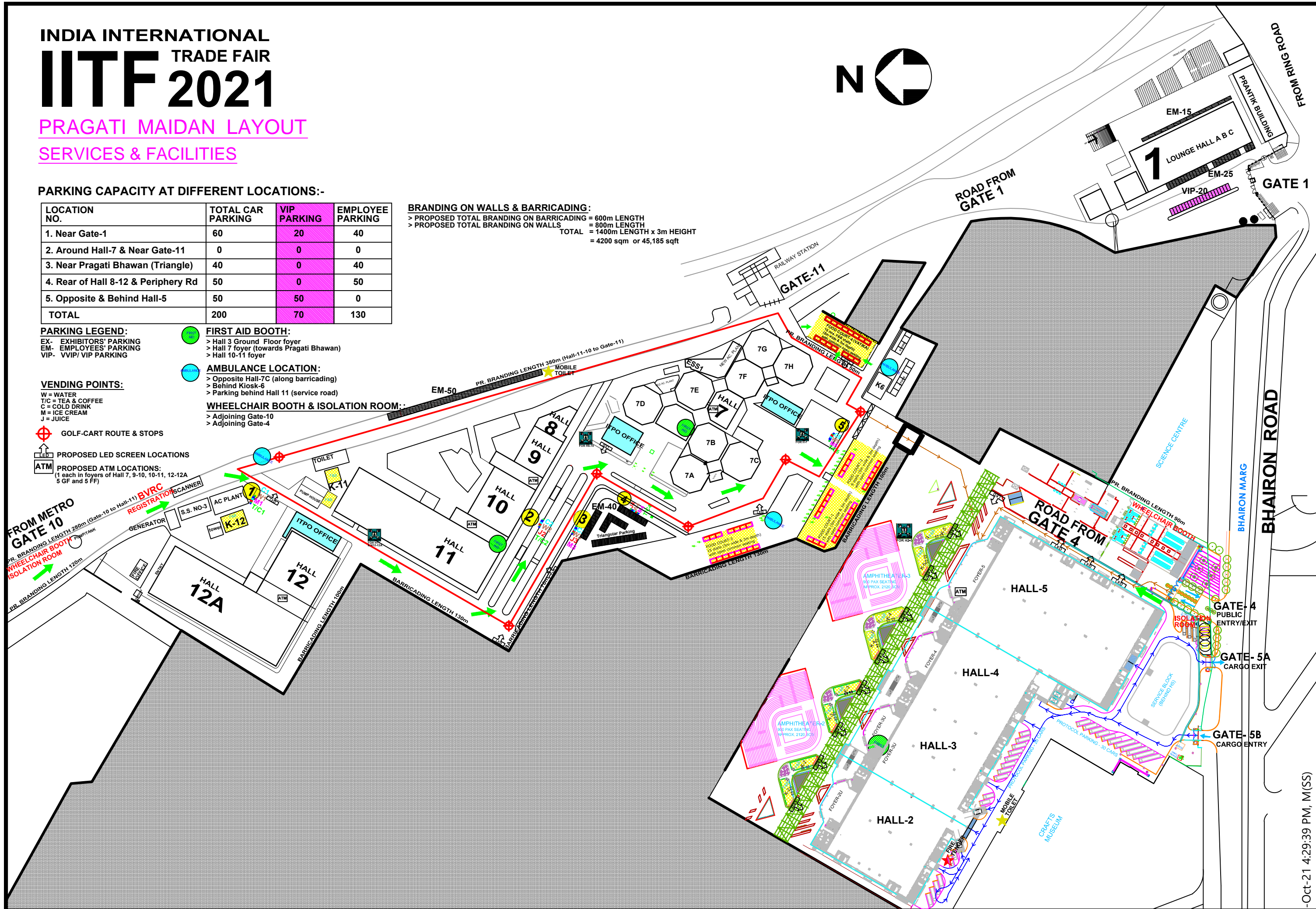

ROAD FROM METRO

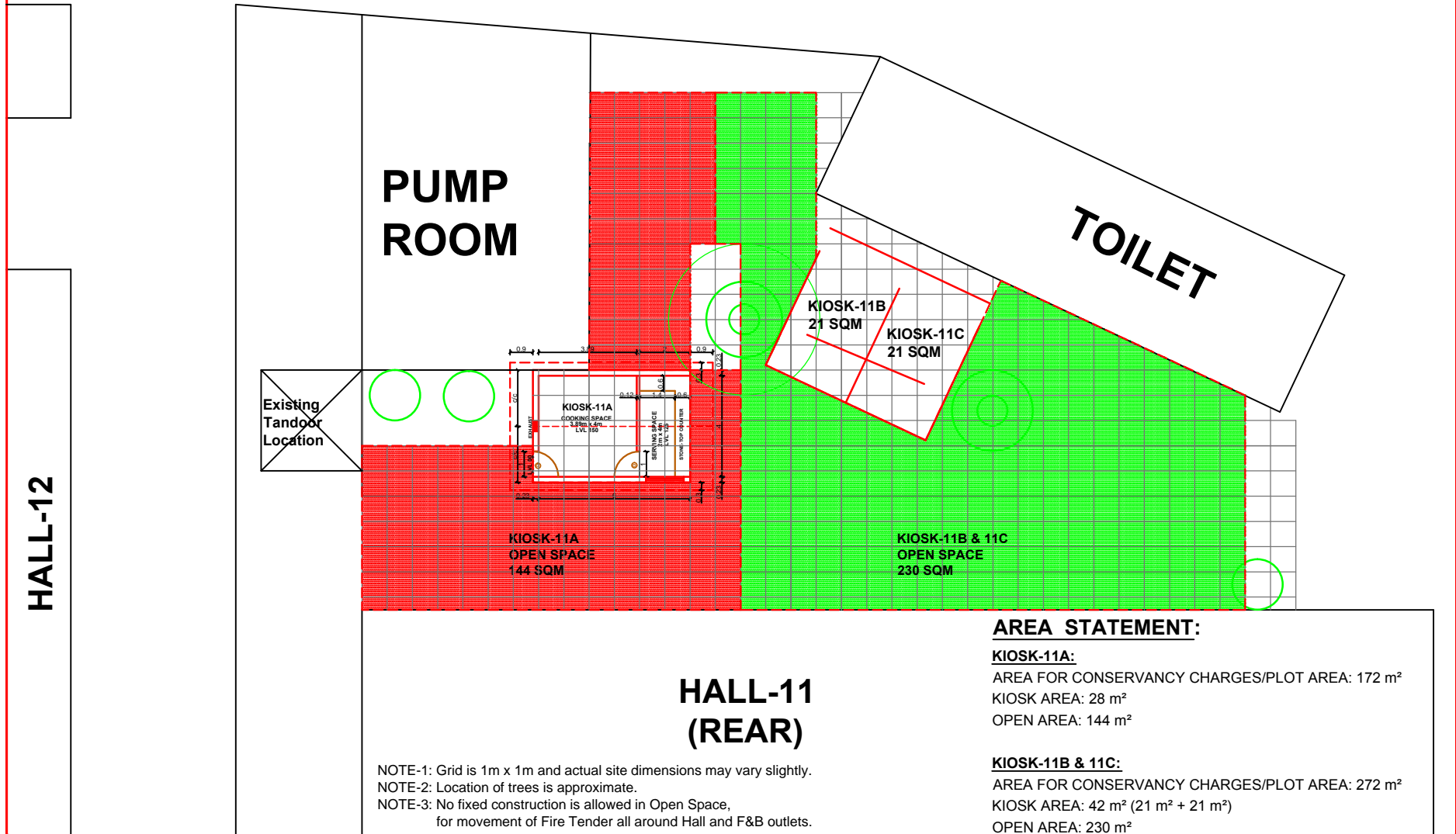

**F&B KIOSK-11**  
BEHIND HALL NO. 11,  
PRAGATI MAIDAN, NEW DELHI

DATE: 20.09.2019	SCALE: FIT TO PAPER	DRAWING NO: DEV/F&B/2019	NORTH:
NOTE :-			
THIS DRG. IS THE PROPERTY OF ITPO, IT SHALL BE USED ONLY FOR THE PURPOSE FOR WHICH IT HAS BEEN ISSUED BY THE ARCHITECTURE DEPARTMENT AMMENDMENTS IF ANY REQUIRED IN THE LAYOUT PLAN SHALL BE GOT APPROVED FROM ARCH.DIVISION.			

V.NO.	REVISION	DATE
SAURABH SHARMA DY. MANAGER (ARCH.)		BRIJ LAL DY. GEN. MANAGER (ARCH.)

INDIA TRADE PROMOTION ORGANISATION
ARCHITECTURE DIVISION
I T P O
PRAGATI MAIDAN, N. DELHI.

SERVICE ROAD FROM GATE-10 (METRO)

ELECTRIC SUBSTATION

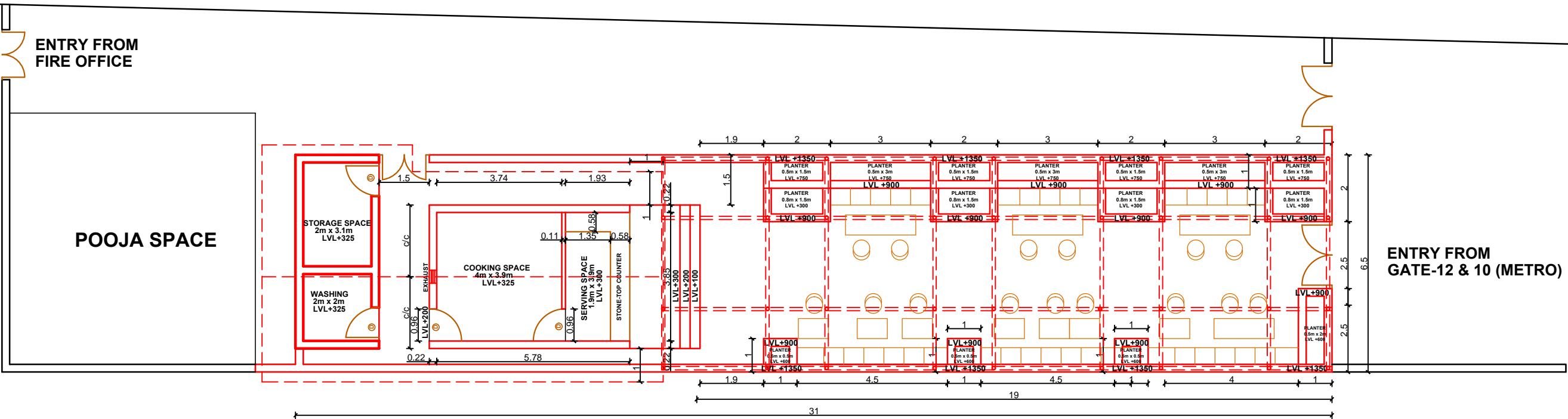

HALL 12-12A REAR LOADING/UNLOADING SPACE

AREA STATEMENT:

PLOT AREA: 201.5 m<sup>2</sup> (31m X 6.5m)  
KIOSK AREA: 23 m<sup>2</sup> (15.6 m<sup>2</sup> COOKING + 7.4 m<sup>2</sup> SERVING)  
SERVICE AREA: 10.2 m<sup>2</sup> (6.2 m<sup>2</sup> STORAGE + 4 m<sup>2</sup> WASHING)  
SEATING AREA: 123.5 m<sup>2</sup> (WITH PLANTERS) (19m x 6.5m)

HALL-12 (REAR)

F&B KIOSK-12  
BEHIND HALL NO. 12,  
PRAGATI MAIDAN, NEW DELHI

DATE: 20.09.2019	SCALE: FIT TO PAPER	DRAWING NO: DEV/F&B/2019	NORTH:
NOTE :-  THIS DRG. IS THE PROPERTY OF ITPO, IT SHALL BE USED ONLY FOR THE PURPOSE FOR WHICH IT HAS BEEN ISSUED BY THE ARCHITECTURE DEPARTMENT.AMMENDMENTS IF ANY REQUIRED IN THE LAYOUT PLAN SHALL BE GOT APPROVED FROM ARCH.DIVISION.			



INDIA TRADE PROMOTION ORGANISATION

ARCHITECTURE DIVISION

I T P O

PRAGATI MAIDAN, N. DELHI.



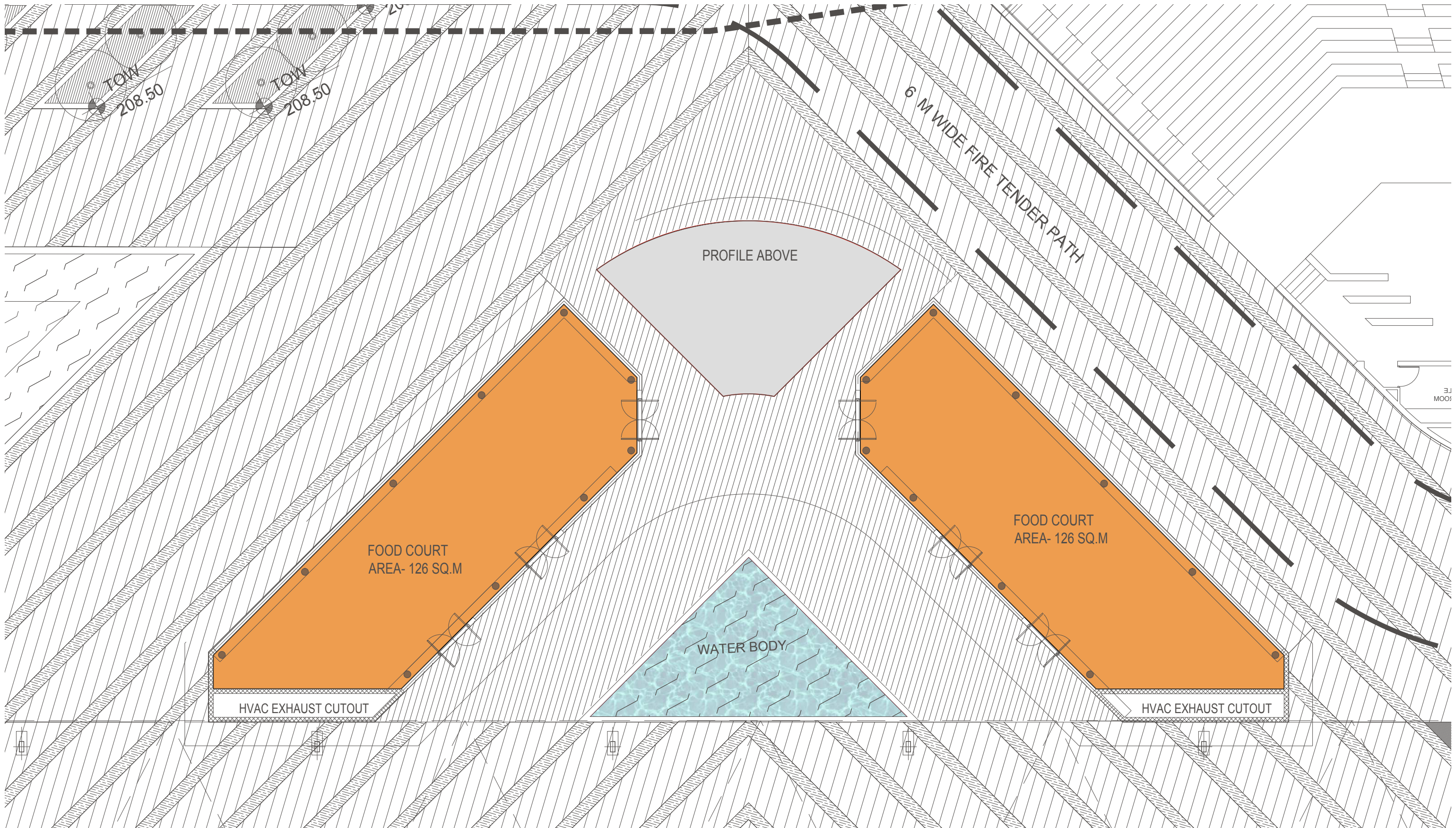

LEGEND		
<span style="display:inline-block; width:15px; height:15px; background-color:orange; border:1px solid black;"></span>	F&B AREA	252 SQ.M