

INDIA INTERNATIONAL  
**IITF 2021** TRADE FAIR

PRAGATI MAIDAN LAYOUT  
SERVICES & FACILITIES

PARKING CAPACITY AT DIFFERENT LOCATIONS:-

LOCATION NO.	TOTAL CAR PARKING	EXHIBITOR PARKING	EMPLOYEE PARKING
1. Near Gate-1	0	0	0
2. Around Hall-7 & Near Gate-11	0	0	0
3. Near Pragati Bhawan	0	0	0
4. Rear of Hall 8-12 & Periphery Rd)	20	0	20
5. Temporary near Hall-5	70	70	0
TOTAL	90	70	20

PARKING LEGEND:  
EX- EXHIBITORS' PARKING  
EM- EMPLOYEES' PARKING  
VIP- VVIP/ VIP PARKING

VENDING POINTS:  
W = WATER  
T/C = TEA & COFFEE  
C = COLD DRINK  
M = ICE CREAM  
J = JUICE

⊕ = GOLF-CART ROUTE & STOPS

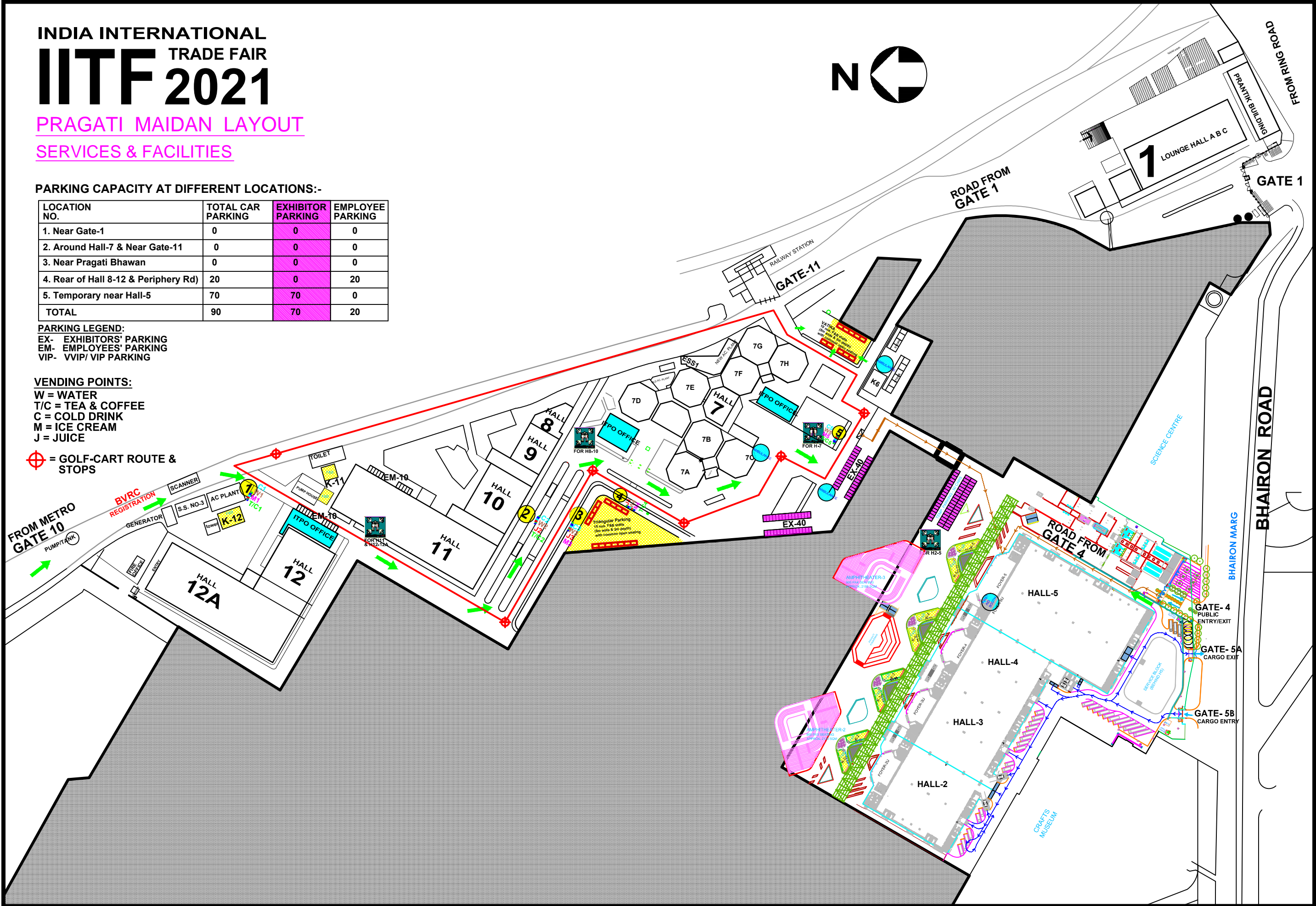

ROAD FROM METRO

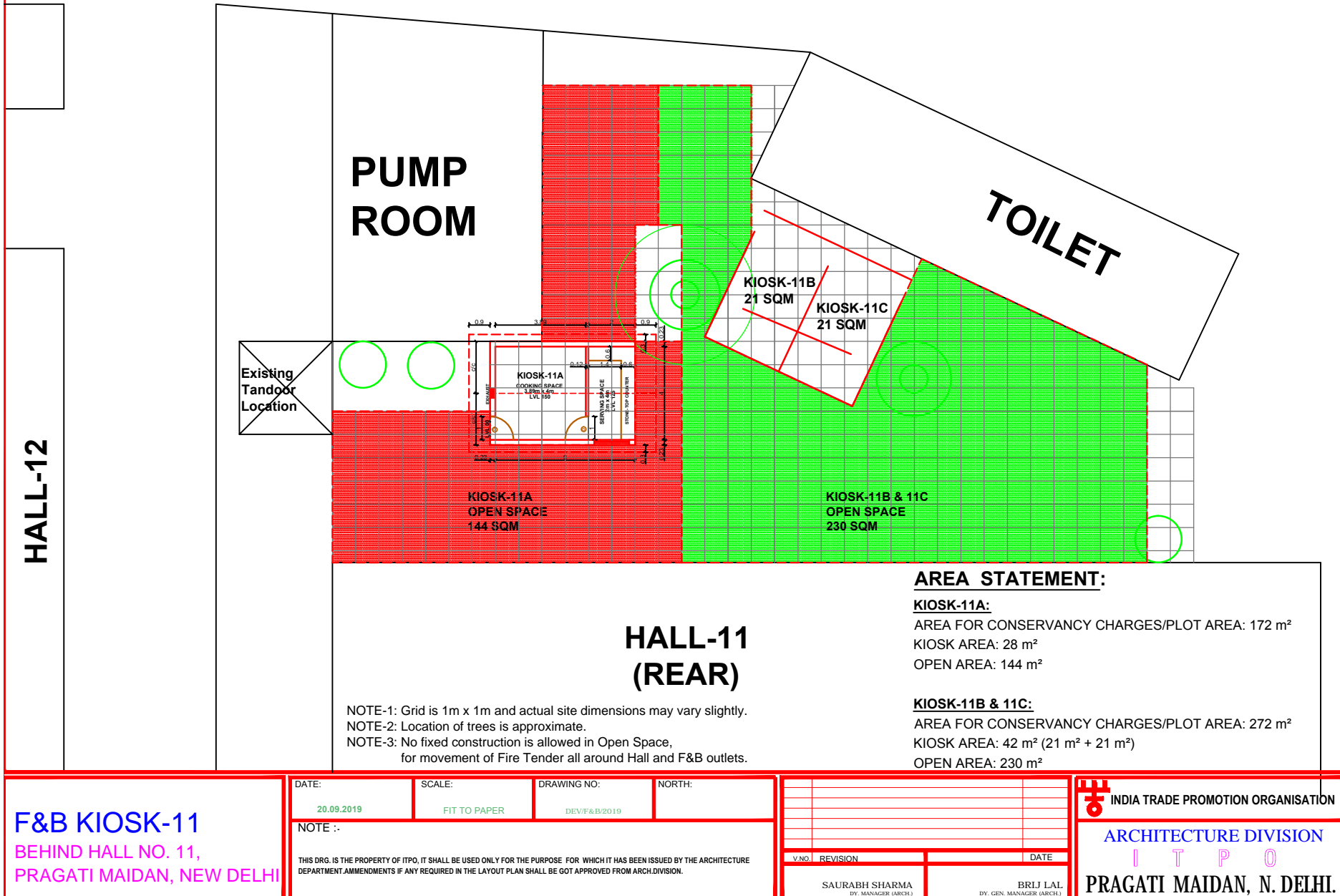

SERVICE ROAD FROM GATE-10 (METRO)

ELECTRIC SUBSTATION

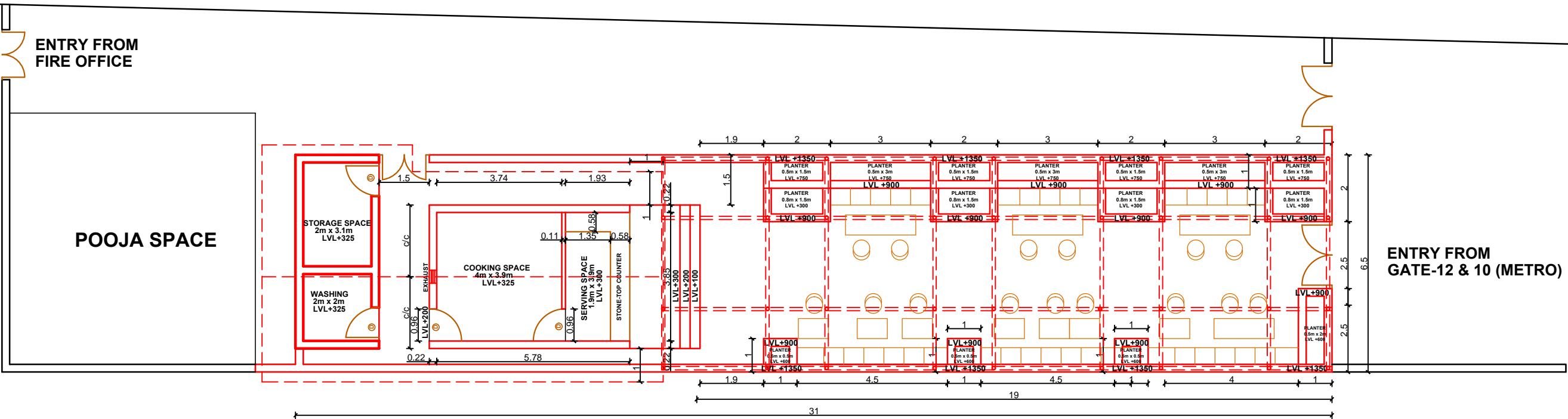

HALL 12-12A REAR LOADING/UNLOADING SPACE

AREA STATEMENT:

PLOT AREA: 201.5 m<sup>2</sup> (31m X 6.5m)  
KIOSK AREA: 23 m<sup>2</sup> (15.6 m<sup>2</sup> COOKING + 7.4 m<sup>2</sup> SERVING)  
SERVICE AREA: 10.2 m<sup>2</sup> (6.2 m<sup>2</sup> STORAGE + 4 m<sup>2</sup> WASHING)  
SEATING AREA: 123.5 m<sup>2</sup> (WITH PLANTERS) (19m x 6.5m)

HALL-12 (REAR)

F&B KIOSK-12  
BEHIND HALL NO. 12,  
PRAGATI MAIDAN, NEW DELHI

DATE: 20.09.2019	SCALE: FIT TO PAPER	DRAWING NO: DEV/F&B/2019	NORTH:
NOTE :-  THIS DRG. IS THE PROPERTY OF ITPO, IT SHALL BE USED ONLY FOR THE PURPOSE FOR WHICH IT HAS BEEN ISSUED BY THE ARCHITECTURE DEPARTMENT.AMMENDMENTS IF ANY REQUIRED IN THE LAYOUT PLAN SHALL BE GOT APPROVED FROM ARCH.DIVISION.			



INDIA TRADE PROMOTION ORGANISATION

ARCHITECTURE DIVISION

I T P O

PRAGATI MAIDAN, N. DELHI.



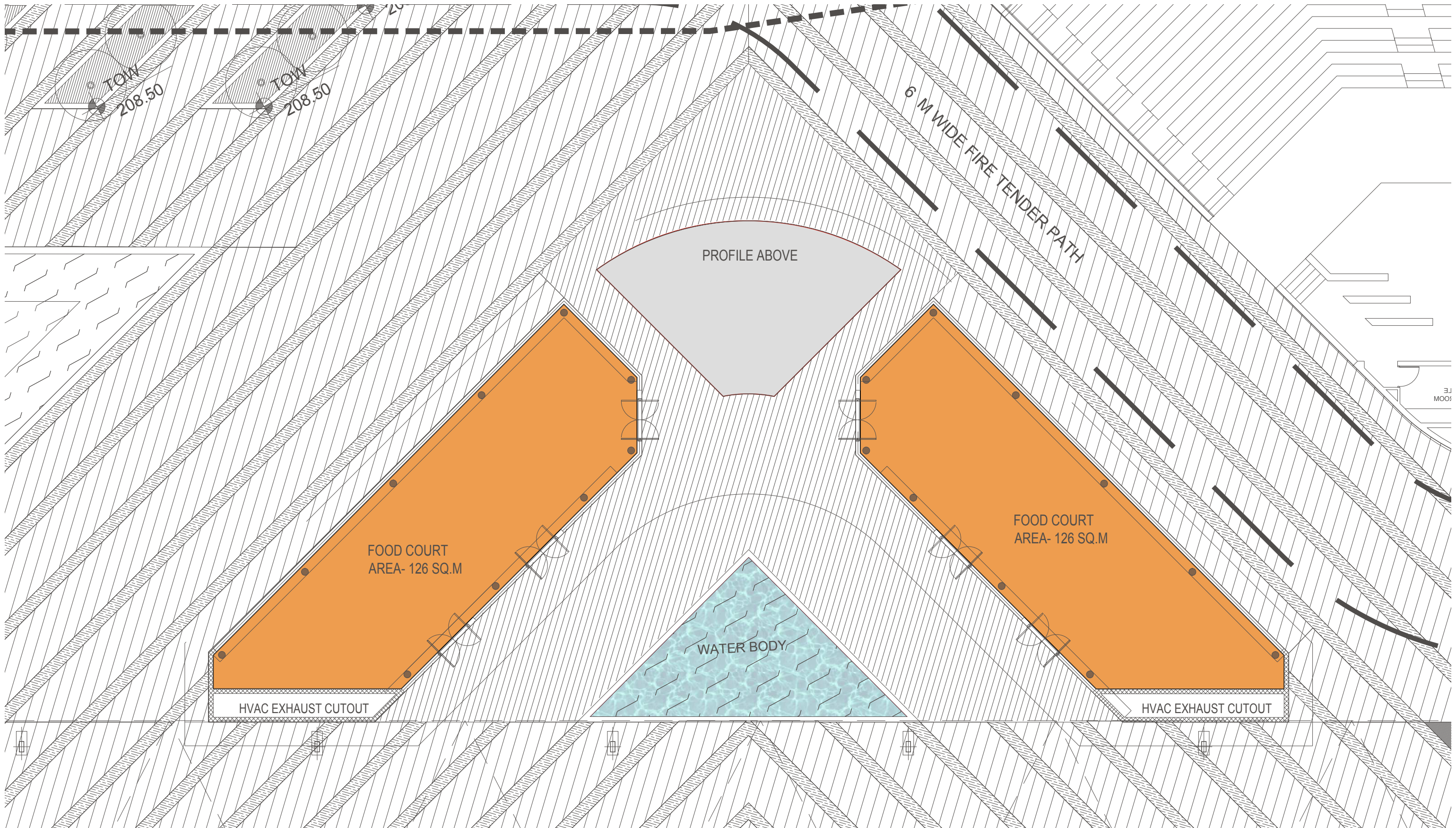

LEGEND		
	F&B AREA	252 SQ.M

