

ROAD FROM METRO

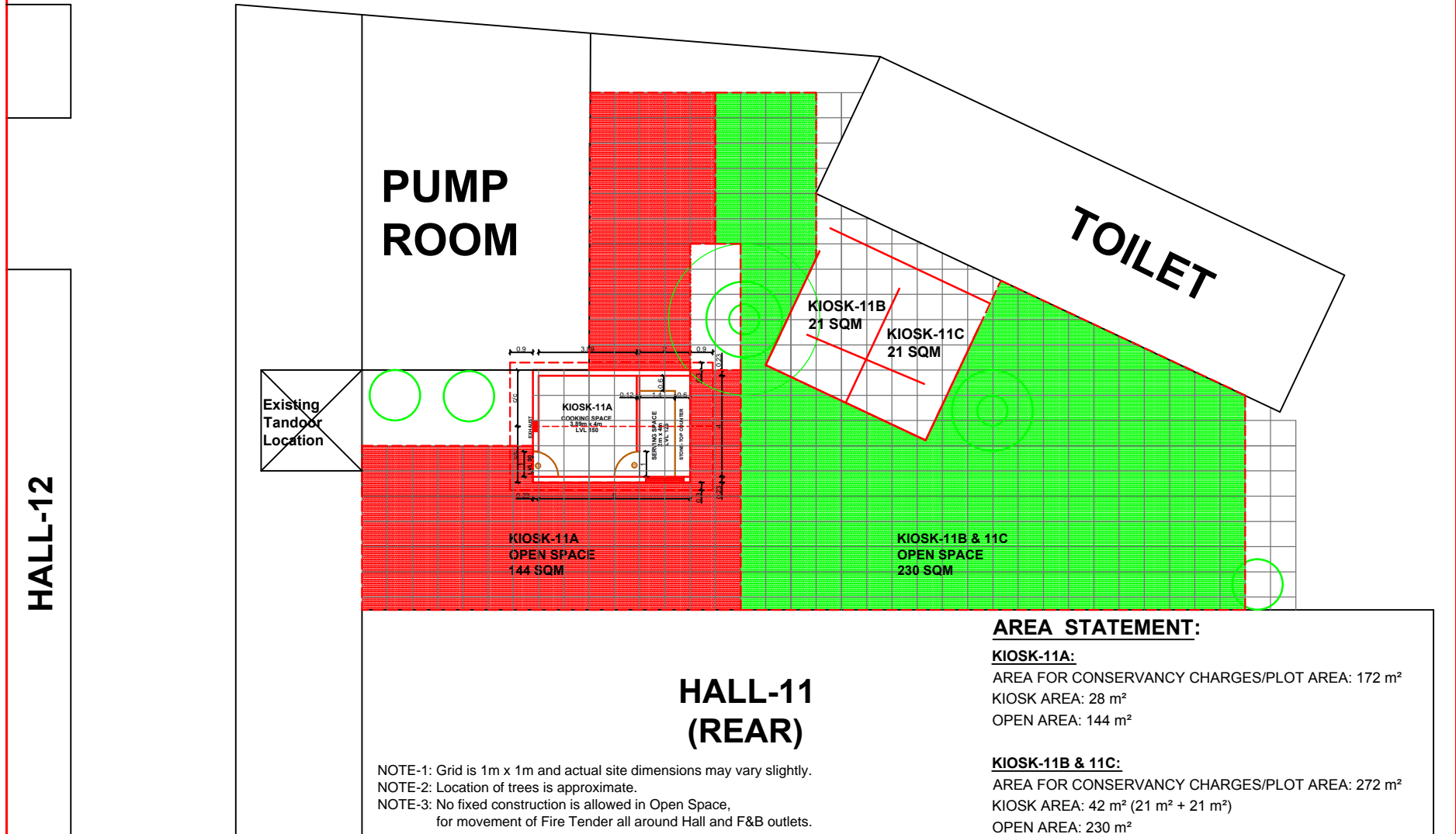

**F&B KIOSK-11**  
BEHIND HALL NO. 11,  
PRAGATI MAIDAN, NEW DELHI

DATE: 20.09.2019	SCALE: FIT TO PAPER	DRAWING NO: DEV/F&B/2019	NORTH:
NOTE :-			
THIS DRG. IS THE PROPERTY OF ITPO, IT SHALL BE USED ONLY FOR THE PURPOSE FOR WHICH IT HAS BEEN ISSUED BY THE ARCHITECTURE DEPARTMENT AMMENDMENTS IF ANY REQUIRED IN THE LAYOUT PLAN SHALL BE GOT APPROVED FROM ARCH.DIVISION.			

V.NO.	REVISION	DATE
SAURABH SHARMA DY. MANAGER (ARCH.)		BRIJ LAL DY. GEN. MANAGER (ARCH.)

INDIA TRADE PROMOTION ORGANISATION
ARCHITECTURE DIVISION
I T P O
PRAGATI MAIDAN, N. DELHI.

SERVICE ROAD FROM GATE-10 (METRO)

ELECTRIC SUBSTATION

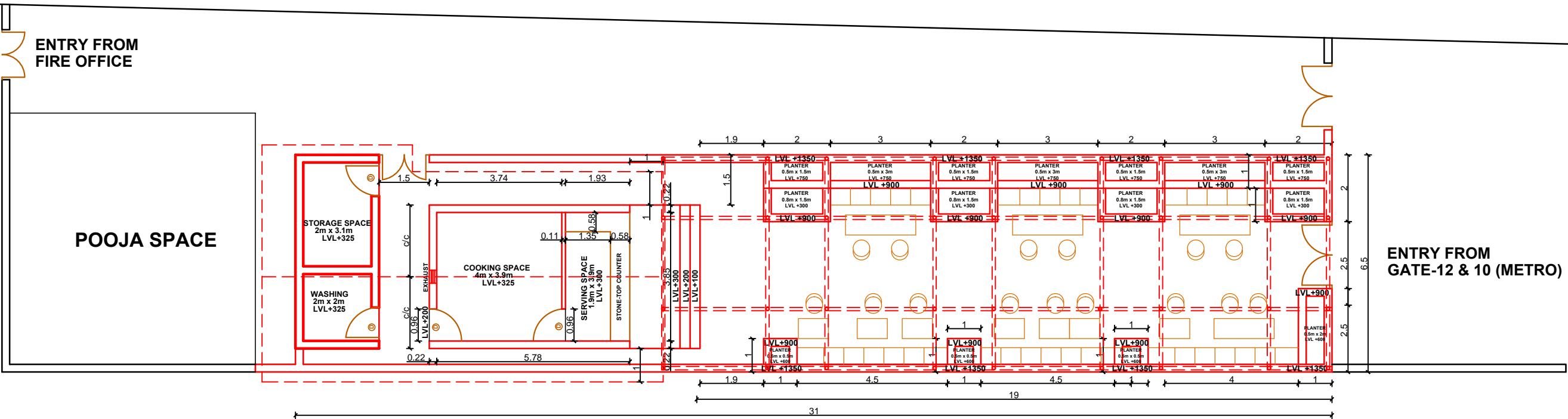

HALL 12-12A REAR LOADING/UNLOADING SPACE

AREA STATEMENT:

PLOT AREA: 201.5 m<sup>2</sup> (31m X 6.5m)  
KIOSK AREA: 23 m<sup>2</sup> (15.6 m<sup>2</sup> COOKING + 7.4 m<sup>2</sup> SERVING)  
SERVICE AREA: 10.2 m<sup>2</sup> (6.2 m<sup>2</sup> STORAGE + 4 m<sup>2</sup> WASHING)  
SEATING AREA: 123.5 m<sup>2</sup> (WITH PLANTERS) (19m x 6.5m)

HALL-12 (REAR)

F&B KIOSK-12  
BEHIND HALL NO. 12,  
PRAGATI MAIDAN, NEW DELHI

DATE: 20.09.2019	SCALE: FIT TO PAPER	DRAWING NO: DEV/F&B/2019	NORTH:
NOTE :-  THIS DRG. IS THE PROPERTY OF ITPO, IT SHALL BE USED ONLY FOR THE PURPOSE FOR WHICH IT HAS BEEN ISSUED BY THE ARCHITECTURE DEPARTMENT.AMMENDMENTS IF ANY REQUIRED IN THE LAYOUT PLAN SHALL BE GOT APPROVED FROM ARCH.DIVISION.			



INDIA TRADE PROMOTION ORGANISATION

ARCHITECTURE DIVISION

PRAGATI MAIDAN, N. DELHI.